



GF Wedding Pricing

- **Event Package Pricing**
 - **Peak Season: April, May, June, September, October, November**
 - **Full Weekend:** \$11,000 (Includes 48 hours of access + 2 nights lodging in home & rehearsal dinner can be hosted on site)
 - **Single Day:** (8 AM – 11 PM)
 - Friday: \$8,500
 - Saturday: \$9,000
 - Sunday: \$8,500
 - **Off-Peak Season: December, January, February, March, July, August**
 - **Full Weekend:** \$9,000 (Includes 48 hours of access + 2 nights lodging in home & rehearsal dinner can be hosted on site)
 - **Single Day:** (8 AM – 11 PM)
 - Friday: \$6,500
 - Saturday: \$7,000
 - Sunday: \$6,500
 - **Events Under 50 on Tuesday or Wednesday:**
 - **Event Center Only (excludes use of home)**
 - \$3,000 (9 AM – 6 PM rental time)
- **Included in event package:**
 - **Summary:**
 - Planning Advisor, Event/Reception Center + Private Loft, (20) 60” Round Dining Tables, Bar on Wheels, Ceremony & Reception Chairs, (12) Whiskey Barrels, Lodging (full weekend guests*), Home Use for “getting ready” (balcony suite and basement suite), access to 150 acres of property, Internet (home and event center), Gazebo/Hot-tub, Fishing Pond, Day-Of Venue Host, Giant Connect Four, Corn-Hole & Bags
 - **Full Detail:**
 - **Planning Advisor:** As the Operators of Guildford Farm, we've seen tons of incredible wedding ideas come to fruition! We've also seen what works well at the venue...and what doesn't. Although we do not serve as your planner/coordinator (nor do we replace the need for a planner), we will serve as you and your planners "strategic advisor" from the day you book with us - until

the morning of your special day! Along with this offering, we will meet with you and your vendors for a 1 hour on-site "vendor walkthrough" once your vendors have been selected (date of meeting must be scheduled several weeks in advance and it is advised this happens 3+ month before your wedding date).

- **Event/Reception Center:** roughly 4,000 square ft indoor facility (temperature controlled). Main reception room is roughly 3,000 square ft and offers a "ceremony wall" with beautiful wood mantel backdrop if indoor ceremony is preferred. Includes spacious bathrooms, catering "prep" kitchen (commercial sink, residential oven + residential refrigerator/freezer combo), a 6 ft long "bar on wheels", space for buffet, space for dancing, large covered porch (perfect for cocktail hour), immediate proximity to main outdoor ceremony site that looks out at the Guildford Farm Lake. Our Private Loft (restroom and TV also included) may be used as Green Room for band and/or "vendor room". It may also be used as an option for "getting ready" by members of the bridal party. Special/private use may be acceptable, but Loft is not open to all guests. The loft also has a deck which overlooks the ceremony field and is a great location for pictures and views of the water/mountains. For Full-Weekend groups, access is allowed in Event Center from 12 PM the day before wedding to 12 AM at conclusion of wedding reception. For Day-Use guests access is allowed 8 AM – 11 PM. Access may be permitted upon approval by Guildford until 10 AM the morning following reception if necessary. While night-before rehearsal dinners are welcomed and encouraged for Full-Weekend groups, "Welcome Parties" of over 45 guests are not included and would be considered an "add on" (requiring additional insurance coverage and cost).
- **(20) 60" Round Dining Tables:** GF owns and provides up to 20 "5 ft round" wood dining tables to accommodate roughly 8 (recommended) guests per table. Lessee's Planner and/or Catering partner will be required to determine use, location, and set up in collaboration with Lessee and Guildford.
- **Bar On Wheels:** GF owns and provides a wood 6 foot long bar in the Event Center (must stay in event center or on front concrete patio).
- **Standard Ceremony Chairs:** (total number based on guest total): basic, white folded with padded seat style. Pictures available on MS Events website ("white folding chair w/ padded seat").
- **Standard Reception Chairs:** (total number based on guest total): fruitwood folding chair with padded seat. Pictures available on MS Events website ("fruitwood folding chair with padded")
- **(12) Whiskey Barrels:** 12 whiskey barrels are provided as décor that may be used to set up decorations, framed photos, flowers, etc. Barrels must be kept in the event center or on either of the concrete patios of event center. Any special use of barrels in another location must be approved by Guildford in advance.
- **Lodging:** Full-weekend Guildford Farm weddings include 48-hour access to the nearly 8,000 square ft home with overnight accommodations for 12 (6 bedrooms, 9 beds). There are 5 bathrooms total. 2 nights lodging is a \$2,400 value when comparing to hotel rooms/other lodging. Extra nights can be added for additional cost (\$500 per extra night for full-weekend groups). May allow up to 16 total guests upon request. If home is used for Rehearsal Dinner, please discuss number of attendees with GF. The home is on a well and septic system that can only support but so much use (guests can bring in toilet cottage OR use event center restrooms if needed).
- **Balcony Suite:** two bed-room, two bathroom suite with balcony overlooking the front lawn.

- **Basement Suite & Hangout:** includes billiards, ping-pong, bar area, flat screen TV with cable
 - **Property use:** Access to 150 acres surrounding the estate including access to walking and hiking trails
 - **Internet:** WiFi in the home with “extenders” to support WiFi use throughout the home/front porch/back patio.
 - **Gazebo use with hot-tub**
 - **Grill use by Gazebo**
 - **Pond use (fishing only):** Catch and Release; Fishing poles and tackle available but recommended to bring your own.
 - **Day of venue host:** a member of Guildford staff be accessible to support vendor questions and guest parking. We do not replace the need for a Planner/Coordinator.
- **Requirements:**
 - Event insurance
 - Wedding planner/coordinator
 - Virginia state guidelines/laws (i.e., alcohol)
 - **Payment:**
 - 50 percent deposit to reserve the date of your wedding
 - Second half due 60 days prior to event
 - We accept check or card
 - **Vendors:**
 - We are happy to provide a list of our preferred/recommended partners including but not limited to photography, rentals, makeup/hair, catering, photo booth, planner/coordinator, etc. (many are listed on our website guildfordfarm.com)
 - **Layout:** Updated real photos of our new center can be found on our Instagram @guildfordfarm

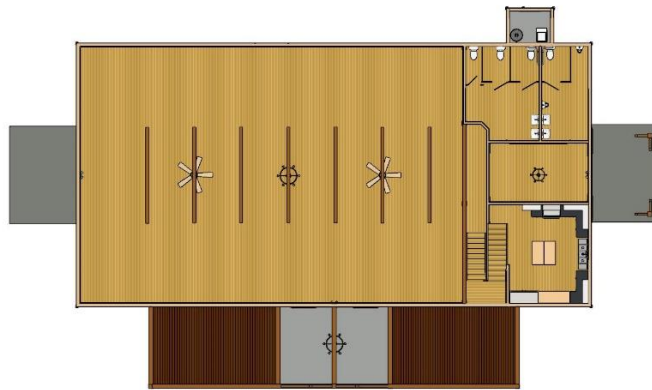

Please Address Questions/Concerns to:

Jonny Kibler
 Event Sales & Business Operations
weddings@guildfordfarm.com
 540-421-7451
 Guildford Farm
 743 Welsh Run Road
 Ruckersville, VA 22968